

# Loudspeaker Test Connection Diagram with Impedance Box

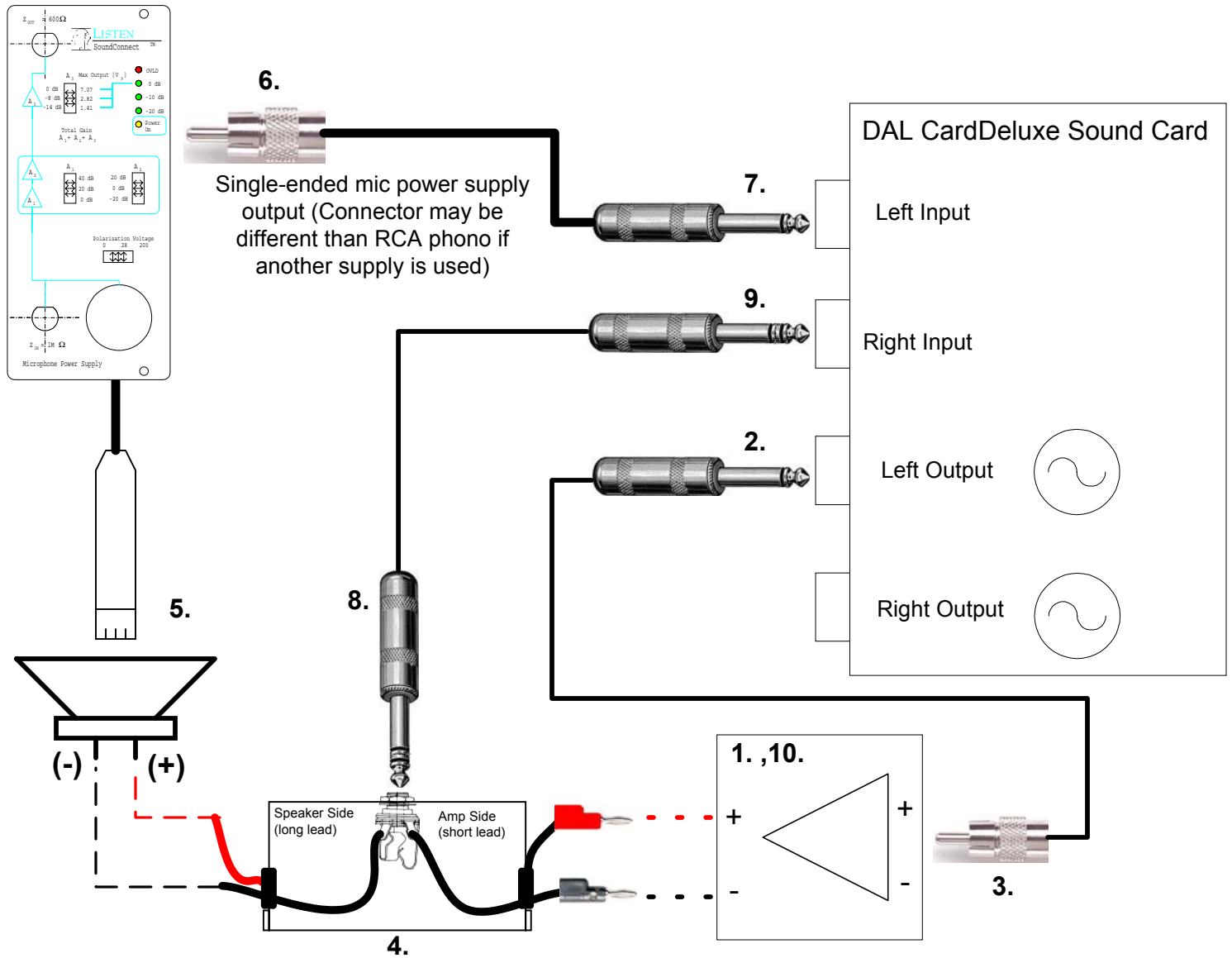

1. Make sure amplifier\* is OFF before connecting any cables.
2. Plug 1/4-inch jack into Left Out of sound card.
3. Plug RCA phono (or other connector type appropriate for your amplifier) to amplifier input channel.
4. Plug Impedance Box banana connectors to amplifier output channel and then connect Impedance Box long leads to loudspeaker.
5. Plug microphone into front of SoundConnect. Make sure appropriate polarization voltage is selected and mic has been calibrated.
6. Plug RCA phono (or other connector type appropriate for your power supply) to output connector on back of SoundConnect.
7. Plug 1/4-inch jack into Left In of sound card. Make sure mic power supply is ON.
8. Plug Tip-Ring-Sleeve (TRS) 1/4-inch jack into Impedance Box.
9. Plug TRS 1/4-jack into Right In of sound card.
10. Turn amplifier ON. You are now ready to run your loudspeaker test sequence. Turn amplifier OFF before shutting down PC to avoid unwanted transients from potentially damaging loudspeaker.

\* Amplifier should be calibrated before making any measurements. Refer to SoundCheck™ instruction manual for details.