

# Microphone Calibration Connection Diagram\*

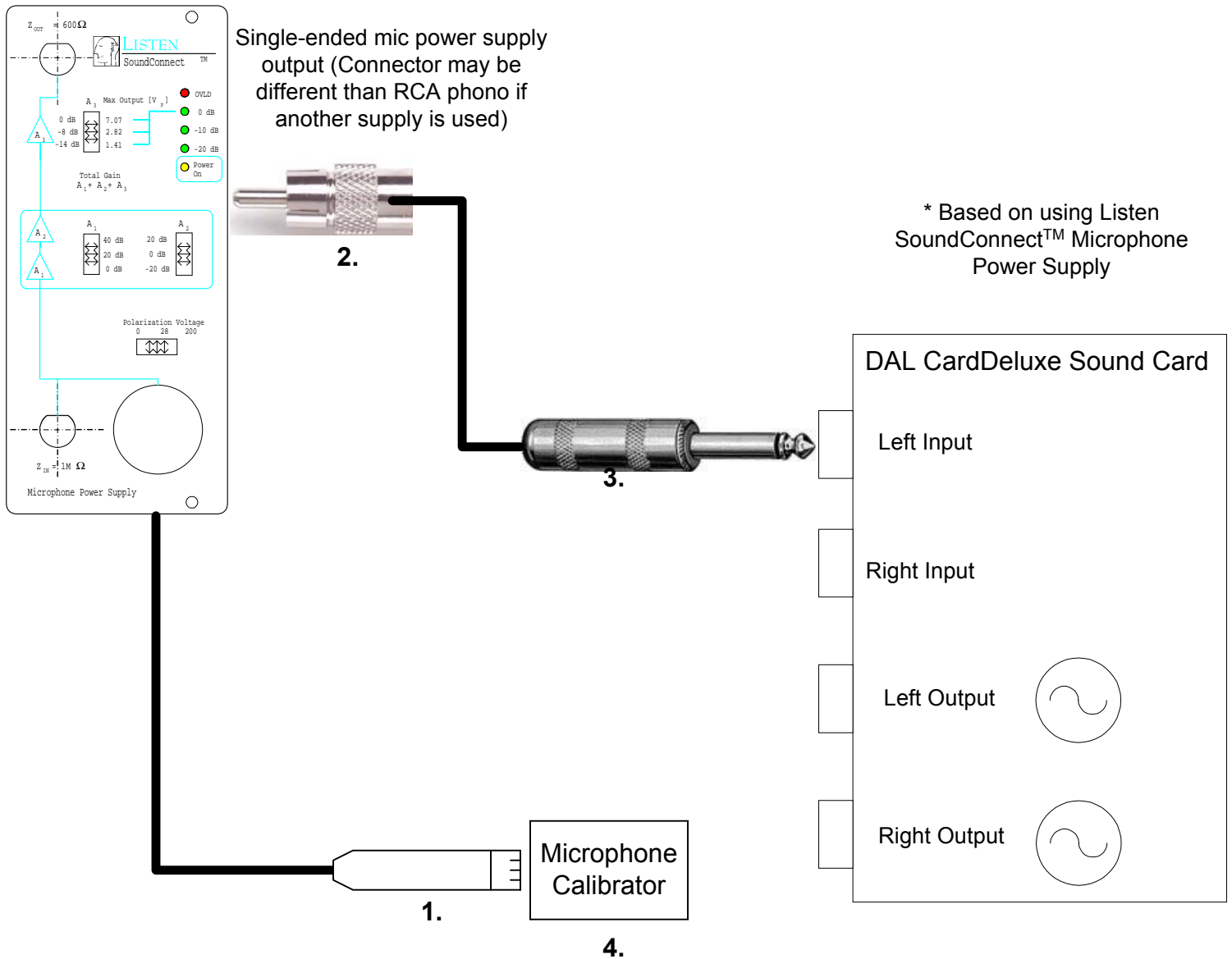

1. Plug microphone into front of SoundConnect. Make sure appropriate polarization voltage is selected.
2. Plug RCA phono (or other connector type appropriate for your power supply) to output connector on back of SoundConnect.
3. Plug 1/4-inch jack into Left In of sound card.
4. Insert microphone into calibrator and turn it on.
5. Press "Calibrate" button in Input section of Calibration Editor to calibrate microphone. Make sure units are V/Pa and dB re 20  $\mu$
6. After calibration is successful, click Save As to save new microphone gain settings to disk or close Calibration Editor and click File -> Save to save the entire sequence.